

# HSF RoHS

REV	ECN NO	DESCRIPTION	DATE	NAME
A	—	NEW	11/28-'19	LZM

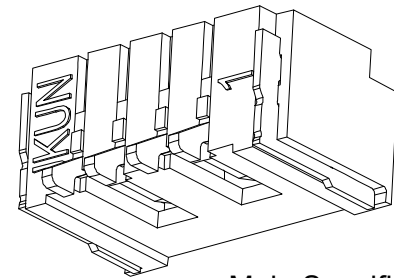

**Main Specifications**  
 Poles: 02 to 16  
 Contact resistance: ≤20m Ω  
 Insulation resistance: ≥100M Ω  
 Rated voltage: 125V AC DC  
 Rated current: 1.0A AC DC  
 Withstand Voltage: 500V AC/minute  
 Temperature Range: -25°C~+105°C

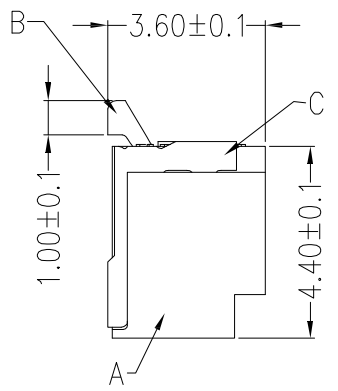
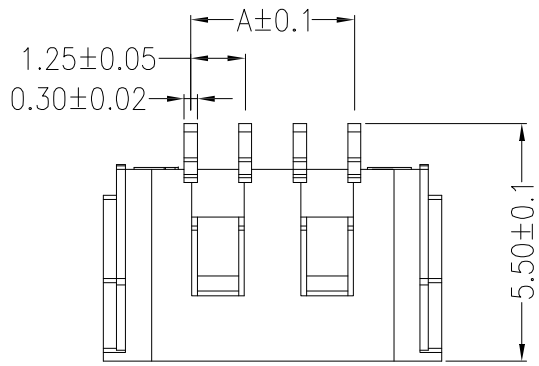
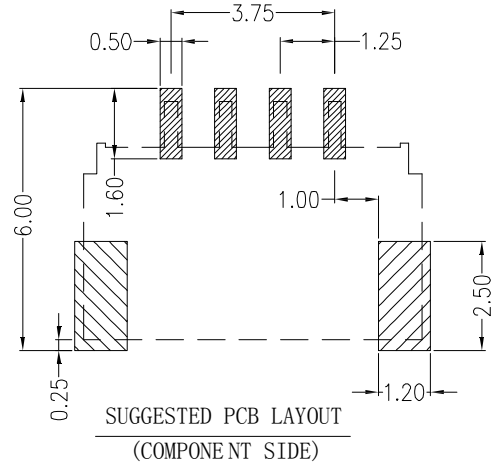
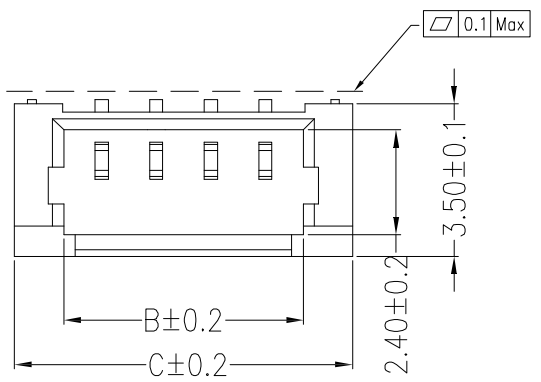

**ORDER INFORMATION:**

<b>L1252AWR-**-F1CA-R-B</b>	
PART No.	SPECIAL CODE: B=CLOSED PASS
No. OF CIRCUITS: 02~16	PACKAGING: R=REEL G=TUBE P=PE
PLASTIC MATERIAL: FIC=LCP (BEIGE)	PLATING: A=Sn

NO.	DESCRIPTION	QTY	MATERIAL	PLATING/COLOR
A	Insulator	1	LCP (UL94V-0)	Beige
B	Contacts	2~16	PhosphorBronze	Tin-plated
C	Solder Tab	2	PhosphorBronze	Tin-plated

Circuit	Dimensions (mm)			Circuit	Dimensions (mm)		
	A	B	C		A	B	C
02	1.25	3.15	5.25	10	11.25	13.15	15.25
03	2.50	4.40	6.50	11	12.50	14.40	16.50
04	3.75	5.65	7.75	12	13.75	15.65	17.75
05	5.00	6.90	9.00	13	15.00	16.90	19.00
06	6.25	8.15	10.25	14	16.25	18.15	20.25
07	7.50	9.40	11.50	15	17.50	19.40	21.50
08	8.75	10.65	12.75	16	18.75	20.65	22.75
09	10.00	11.90	14.00				

STANDARD TOLERANCE (EXCEPT SPECIFIED)	
LINER	ANGLES
.0 ±0.30	0.° ±5°
.00 ±0.25	.0° ±2°
.000 ±0.10	.00° ±1°

**LDCONN 东莞连大精密制品有限公司**  
 连大 DongGuan LianDa Precision Products Co., LTD

TITLE	1.25mm PITCH 90° Wafer SMT TYPE	DRAWN BY	LZM	11/28-'19
PART NO.	L1252AWR-XX-F1CA-R-B	CHECKED BY		
DRAWING NO.		APPROVED BY		
SCALE	1:1	UNIT	mm	PAGE 1/1
				SIZE A4